

Order Repair Kits Online and Individual Parts by Phone.

**1-1/2" & 2" Cast Iron Pump Repair Parts**

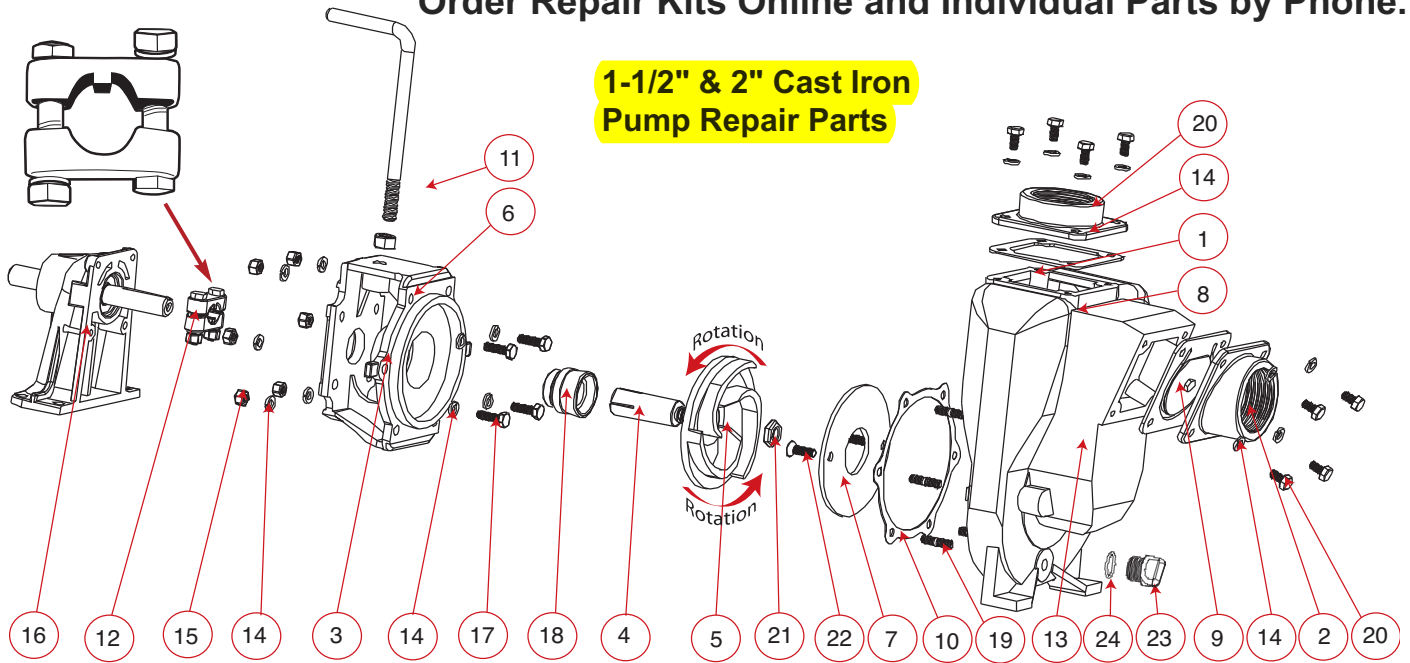

REPLACEMENT PARTS 1½" CAST IRON PUMPS			
ITEM	PART NO	DESCRIPTION	QTY
1	17001	Threaded Outlet Flange	1
2	17003	Threaded Inlet Flange	1
3	17004	C-Flange Adapter	1
4	17006	¾" Sleeve Drive	1
5	17008*	5" Impeller	1
5	17008-4.6	4.6" Trimmed Impeller	1
5	17008-4.1	4.1" Trimmed Impeller	1
6	17010	½" Hex Nut	1
7	17011	Wear Plate	1
8	17013	EPDM Gasket	1
9	17016	Check Valve Assembly	1
10	17018	Gasket Adapter	1
11	15022	Handle	1
12	17023	⅝" Clamp for ¾" Shaft Assembly (Old Style)	1
12	17123	⅝" Clamp for ¾" Shaft Assembly (Keyed)	1
12	17024	⅞" Clamp for Shaft Assembly	1
13	17026	Pump Housing	1
14	V10118	⅝" Lock Washer	18
15	V10119	⅝" - 18 SS Hex Nut	6
N/S	12882R	Housing	1
N/S	12883R	Bearing Pedestal w/ ¾" Shaft Only	1
N/S	12884	Internal Retaining Clip for Pedestal	1
N/S	12883B	Bearings	2
16	12882A	Complete Pedestal Assembly	1
17	17040	⅝" -24 x 1.00" Cap Screw	4
18	17028	EPDM Seal Assembly	1
18	17035*	FKM (viton type) Seal Assembly	1
18	17035SD	Severe Duty Seal	1
19	17042	Stud	6
20	17019	⅝" -18 x ¾" Cap Screw	8
21	17009B	⅝" Impeller Nut	1
22	17130	C Sink Flat Head Screw	2
23	12777	Plug	1
24	UV15163	O-Ring	1
N/S	17033	Z Rails (Pair)	1
N/S	17100	Repair Kit (Consists of items 4, 5*, 7, 10, 18*)	1

REPLACEMENT PARTS 2" CAST IRON PUMPS			
ITEM	PART NO	DESCRIPTION	QTY
1	17000	Threaded Outlet Flange	1
1	M17000	2" Manifold Outlet Flange	1
2	17002	Threaded Inlet Flange	1
2	M17002	2" Manifold Inlet Flange	1
3	17004	C-Flange Adapter	1
4	17006	¾" Sleeve Drive	1
5	17008*	5" Impeller	1
5	17008-4.6	4.6" Trimmed Impeller	1
5	17008-4.1	4.1" Trimmed Impeller	1
6	17010	½" Hex Nut	1
7	17011	Wear Plate	1
8	17013	EPDM Gasket	1
9	17016	Check Valve Assembly	1
10	17018	Gasket Adapter	1
11	15022	Handle	1
12	17023	⅝" Clamp for ¾" Shaft Assembly (Old Style)	1
12	17123	⅝" Clamp for ¾" Shaft Assembly (Keyed)	1
12	17024	⅞" Clamp for Shaft Assembly	1
13	17026	Pump Housing	1
14	V10118	⅝" Lock Washer	18
15	V10119	⅝" - 18 SS Hex Nut	6
N/S	12882R	Housing	1
N/S	12883R	Bearing Pedestal w/ ¾" Shaft Only	1
N/S	12884	Internal Retaining Clip for Pedestal	1
N/S	12883B	Bearings	2
16	12882A	Complete Pedestal Assembly	1
17	17040	⅝" -24 x 1.00" Cap Screw	4
18	17028	EPDM Seal Assembly	1
18	17035*	FKM (viton type) Seal Assembly	1
18	17035SD	Severe Duty Seal	1
19	17042	Stud	6
20	17019	⅝" -18 x ¾" Cap Screw	8
21	17009B	⅝" Impeller Nut	1
22	17130	C Sink Flat Head Screw	2
23	12777	Plug	1
24	UV15163	O-Ring	1
N/S	17033	Z Rails (Pair)	1
N/S	17100	Repair Kit (Consists of items 4, 5*, 7, 10, 18*)	1